



# SFP Wizard

## UACC-SFP-Wizard

Instantly reprogram, test, and unlock universal compatibility for every optical module — with full diagnostics and OTA updates built in.

### Mechanical

**Dimensions** 90.8 x 52.1 x 20.2 mm (3.6 x 2.1 x 0.8")

**Weight** 84 g (3 oz)

**Enclosure Material** Polycarbonate

### Hardware

**Networking Interface** BLE

**Power Method** Li-ion battery

**Battery Life** Up to 75 minutes of continuous SFP transceiver diagnostics with laser on, or 35 minutes with QSFP transceivers

**Power Supply** Rechargeable Li-ion battery, 3.7V DC, 300mAh

**Supported Voltage Range** USB-C: 5V DC/0.5A

**Max. Power Consumption** 0.6W

**Supported Form Factor** SFP, SFP+, SFP28, QSFP+, QSFP28

**LCM Display** 1.9" touchscreen

**Buttons** (1) Power

**Ambient Operating Temperature** 0 to 40° C (32 to 104° F)

**Ambient Operating Humidity** 10 to 90% noncondensing

**NDAA Compliant** ✓

**Certifications** FCC, IC, CE

### Software

**Application Requirements** Mobile App

**UniFi iOS™** version 10.29.1 and later

**UniFi Android™** version 10.30.2 and later

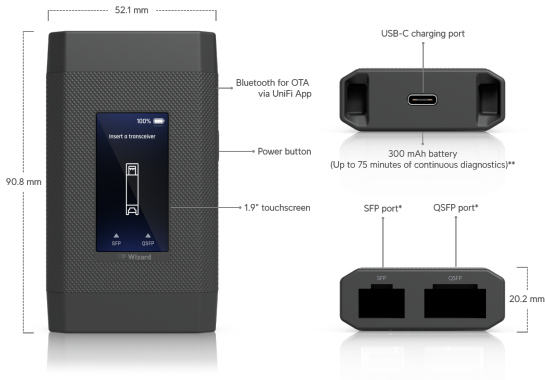

\*Supports SFP, SFP+, SFP28, QSFP+, QSFP28 form factor.

\*\*Supports up to 75 minutes of continuous SFP transceiver diagnostics with laser on, or 35 minutes with QSFP transceivers.